

**DESIGN  
LUCE**  
ZER075

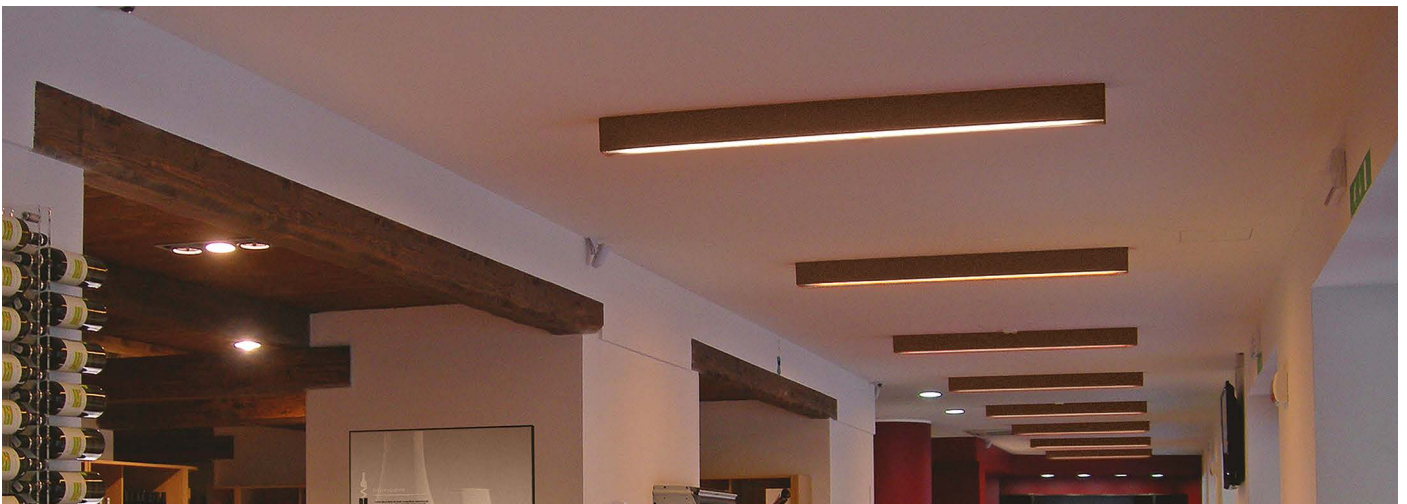

DISEGNIAMO CON LA LUCE

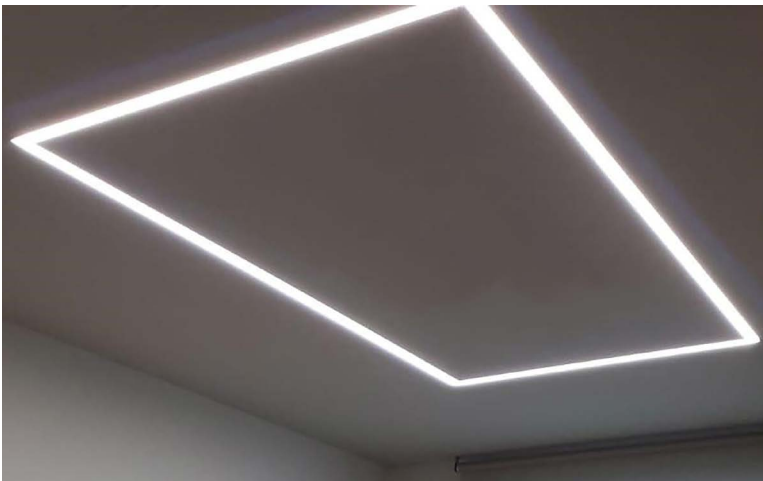
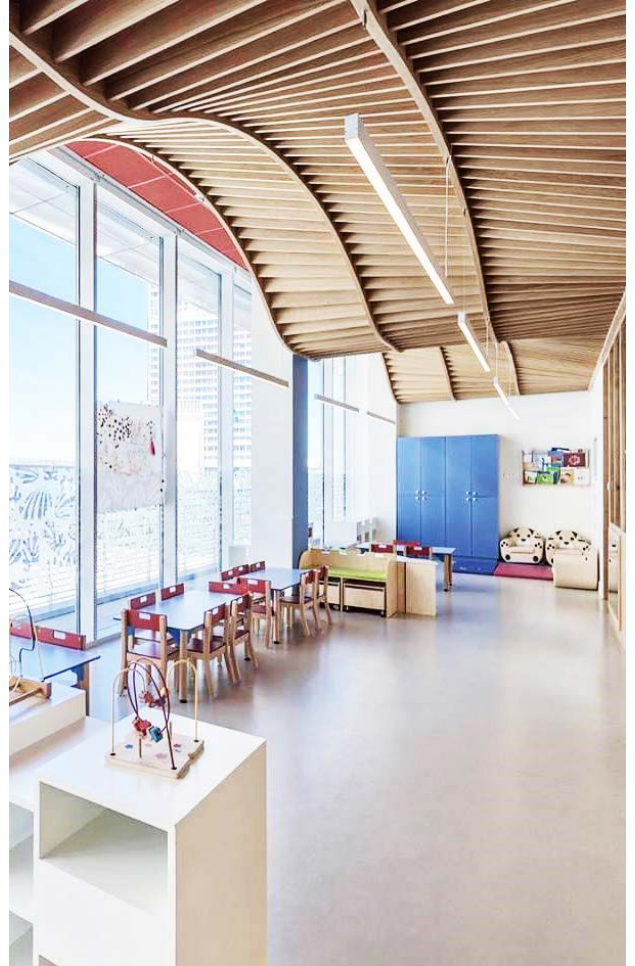

## CONFIGURAZIONI / CONFIGURATIONS

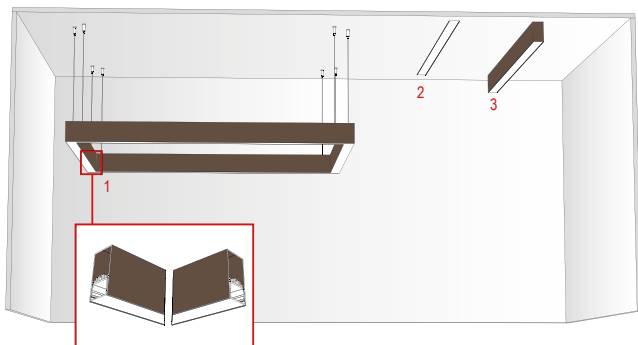

**1. SOSPENSIONE**  
ANGOLO 90° ORIZZONTALE

**1. SUSPENSION**  
HORIZONTAL 90° ANGLE

**ACCESSORI E LAVORAZIONI**  
ACCESSORIES AND PROCESSING

GIUNTO MECCANICO  
MECHANICAL JOINT  
KIT SOSPENSIONE  
SUSPENSION KIT  
TAGLIO ANGOLARE  
CORNER CUT

**2. INCASSO / RECESSED**

ACCESSORI RICHIESTI  
ACCESSORIES REQUIRED  
STAFFA PER INCASSO  
BUILT-IN BRACKET

**3. SUPERFICIE / SURFACE**

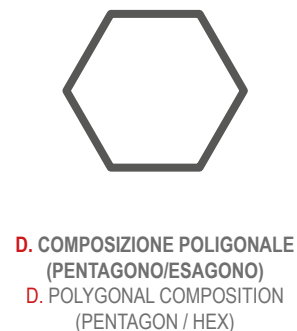
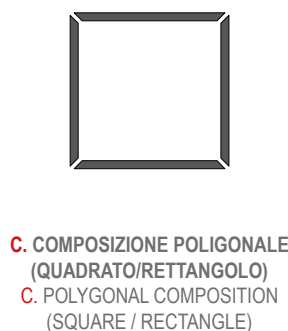

LE COMPOSIZIONI SOPRA RIPORTATE POSSONO ESSERE REALIZZATE PER INSTALLAZIONE A SOSPENSIONE / SOFFITTO-PARETE / INCASSO.  
PER LE COMPOSIZIONI POLIGONALI RIVOLGERSI AL NOSTRO REPARTO TECNICO.

THE ABOVE COMPOSITIONS CAN BE MADE FOR SUSPENSION / SURFACE / BUILT-IN INSTALLATION.  
FOR POLYGONAL COMPOSITIONS, PLEASE CONTACT OUR TECHNICAL DEPARTMENT.

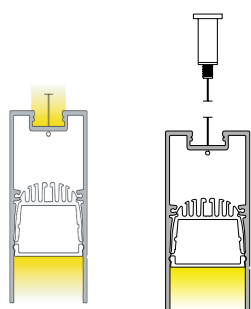

INSTALLAZIONE A SOSPENSIONE  
SUSPENSION

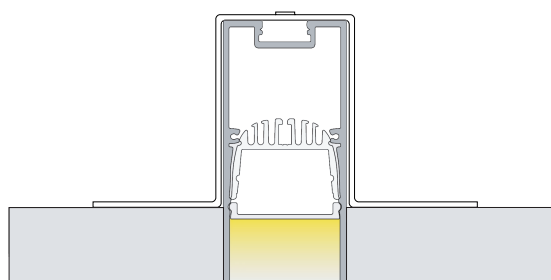

INSTALLAZIONE A INCASSO IN CARTONGESSO  
RECESSED INSTALLATION IN PLASTERBOARD

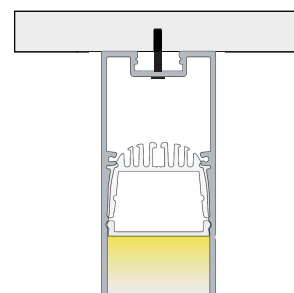

INSTALLAZIONE A SOFFITTO  
CEILING INSTALLATION

### ATTENZIONE!

GLI ACCESSORI PER L'INSTALLAZIONE A INCASSO SONO STATI DIMENSIONATI PER UN PANNELLO STANDARD IN CARTONGESSO DI SPESSORE 12,5 mm

### WARNING!

THE BUILT-IN INSTALLATION ACCESSORIES HAVE BEEN DIMENSIONED FOR A STANDARD PLASTERBOARD PANEL OF 12.5 mm THICKNESS

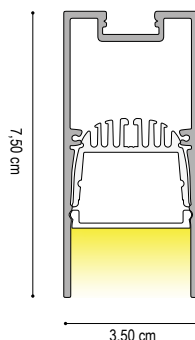

## DATI TECNICI TECHNICAL DATA

	1 cm - 2700K	1 cm - 3000K	1 cm - 4000K
Nominal LED Flux:	2100 lm/m	2200 lm/m	2300 lm/m
Flux Tot:	1680 lm/m	1760 lm/m	1700 lm/m
Output:	105 lm/W	110 lm/W	115 lm/W
CCT:	2700 K	3000 K	4000 K
CRI:	>95	>95	>95
<b>Power Tot:</b>	<b>20.0 W/m</b>	<b>20.0 W/m</b>	<b>20.0 W/m</b>
Weight:	0.90 Kg/m	0.90 Kg/m	0.90 Kg/m
Alluminio/aluminium		Cover: Opale/opal	

## DATI TECNICI TECHNICAL DATA

	1 cm - 2700K	1 cm - 3000K	1 cm - 4000K
Nominal LED Flux:	2100 lm/m	2200 lm/m	2300 lm/m
Flux Tot:	1890 lm/m	1980 lm/m	2115 lm/m
Output:	105 lm/W	110 lm/W	115 lm/W
CCT:	2700 K	3000 K	4000 K
CRI:	>95	>95	>95
<b>Power Tot:</b>	<b>20.0 W/m</b>	<b>20.0 W/m</b>	<b>20.0 W/m</b>
Weight:	0.90 Kg/m	0.90 Kg/m	0.90 Kg/m
Alluminio/aluminium		Cover: Prismaticata/Prismatic	

## DATI TECNICI TECHNICAL DATA

	1 cm - 2700K	1 cm - 3000K	1 cm - 4000K
Nominal LED Flux:	2916 lm/m	3024 lm/m	3125 lm/m
Flux Tot:	2333 lm/m	2419 lm/m	2500 lm/m
Output:	135 lm/W	140 lm/W	145 lm/W
CCT:	2700 K	3000 K	4000 K
CRI:	>95	>95	>95
<b>Power Tot:</b>	<b>22 W/m</b>	<b>22 W/m</b>	<b>22 W/m</b>
Weight:	0.90 Kg/m	0.90 Kg	0.90 Kg
Alluminio/aluminium		Cover: Opale/opal	

## DATI TECNICI TECHNICAL DATA

	1 cm - 2700K	1 cm - 3000K	1 cm - 4000K
Nominal LED Flux:	2916 lm/m	3024 lm/m	3125 lm/m
Flux Tot:	2624 lm/m	2722 lm/m	2812 lm/m
Output:	135 lm/W	140 lm/W	145 lm/W
CCT:	2700 K	3000 K	4000 K
CRI:	>95	>95	>95
<b>Power Tot:</b>	<b>22 W/m</b>	<b>22 W/m</b>	<b>22 W/m</b>
Weight:	0.90 Kg/m	0.90 Kg	0.90 Kg
Alluminio/aluminium		Cover: Prismaticata/Prismatic	

**DATI TECNICI**  
TECHNICAL DATA

	1 cm - 2700K	1 cm - 3000K	1 cm - 4000K
Nominal LED Flux:	3750 lm/m	3900 lm/m	4050 lm/m
Flux Tot:	3120 lm/m	3240 lm/m	3570 lm/m
Output:	125 lm/W	130 lm/W	135 lm/W
CCT:	2700 K	3000 K	4000 K
CRI:	>90	>90	>90
<b>Power Tot:</b>	<b>30.0 W/m</b>	<b>30.0 W/m</b>	<b>30.0 W/m</b>
Weight:	0.90 Kg/m	0.90 Kg/m	0.90 Kg/m

Alluminio/aluminium

Cover: Opale/opal

**DATI TECNICI**  
TECHNICAL DATA

	1 cm - 2700K	1 cm - 3000K	1 cm - 4000K
Nominal LED Flux:	3900 lm/m	4050 lm/m	4200 lm/m
Flux Tot:	3375 lm/m	3510 lm/m	3645 lm/m
Output:	130 lm/W	135 lm/W	140 lm/W
CCT:	2700 K	3000 K	4000 K
CRI:	>90	>90	>90
<b>Power Tot:</b>	<b>30.0 W/m</b>	<b>30.0 W/m</b>	<b>30.0 W/m</b>
Weight:	0.90 Kg/m	0.90 Kg/m	0.90 Kg/m

Alluminio/aluminium

Cover: Prismaticata/Prismatic

**FINITURE / FINISHES**



**VERNICIATURA A POLVERE / POWDER COATING**